

Helping your children choose books they will love



Lovereading4kids.co.uk is a book website created for parents and children to make choosing books easy and fun

Opening extract from
The Way to the Zoo

Written & Illustrated by
John Burningham

Published by
Walker Books Ltd

All Text is Copyright © of the Author and/or Illustrator

Please print off and read at your leisure.



For Sylvie, who always puts you through.

First published 2014 by Walker Books Ltd
87 Vauxhall Walk, London SE11 5HJ

10 9 8 7 6 5 4 3 2 1

© 2014 John Burningham

The right of John Burningham to be identified as author/illustrator of this work has been asserted by him in accordance with the Copyright, Designs and Patents Act 1988

This book has been typeset in URW Egyptianne T

Printed in China

All rights reserved. No part of this book may be reproduced, transmitted or stored in an information retrieval system in any form or by any means, graphic, electronic or mechanical, including photocopying, taping and recording, without prior written permission from the publisher.

British Library Cataloguing in Publication Data:
a catalogue record for this book is available from
the British Library

ISBN 978-1-4063-4840-8

www.walker.co.uk



The Way to the Zoo

JOHN BURNINGHAM



WALKER BOOKS
AND SUBSIDIARIES
LONDON • BOSTON • SYDNEY • AUCKLAND

Copyright © [first year of publication] Individual author and/or Walker Books Ltd. All rights reserved.

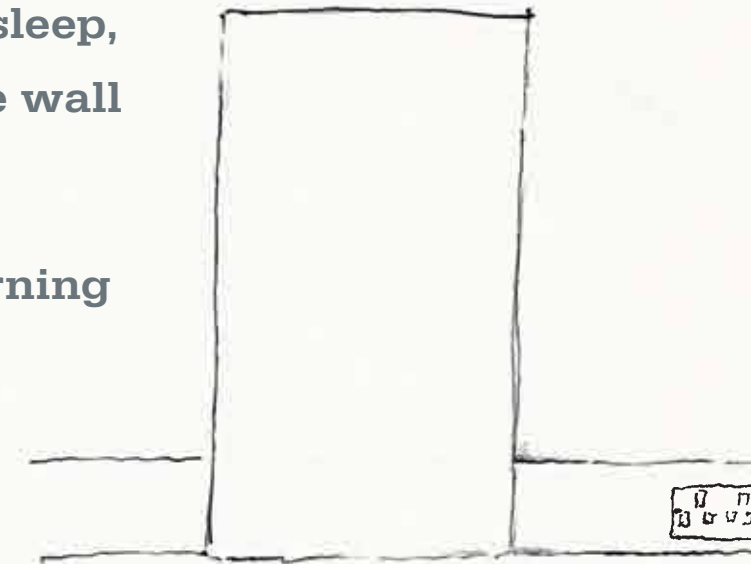

One evening, just before Sylvie went to sleep, she thought she could see a door in the wall of her bedroom.

Sylvie decided to look again in the morning to see if the door was really there.



**In the morning, Sylvie was late for school
and forgot about the door until bedtime.**



**When Sylvie was ready for bed
she found the door and managed to open it.
She could see some steps going down,
and beyond there was a passage.**



Sylvie found the torch and went down the steps and along the passage for a while, wondering where it would go to.

In the distance, she could see what seemed to be another door.

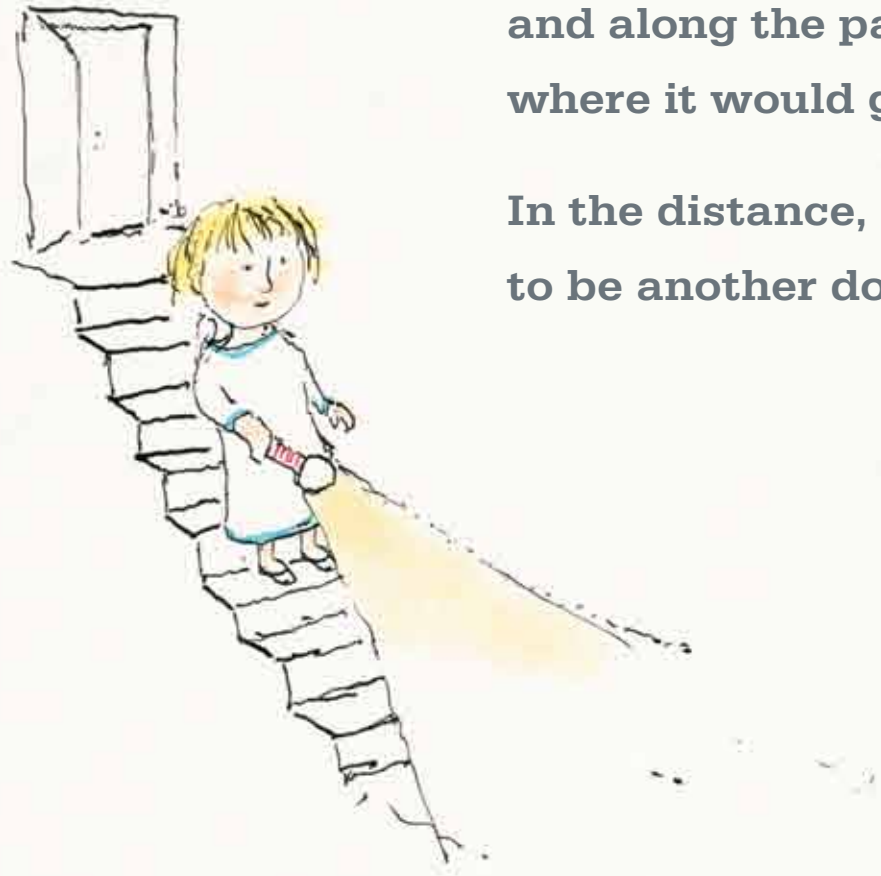

The door was very difficult to open,
but Sylvie used all her strength
and at last it opened.

Sylvie found herself in the zoo
with lots of animals looking at her.

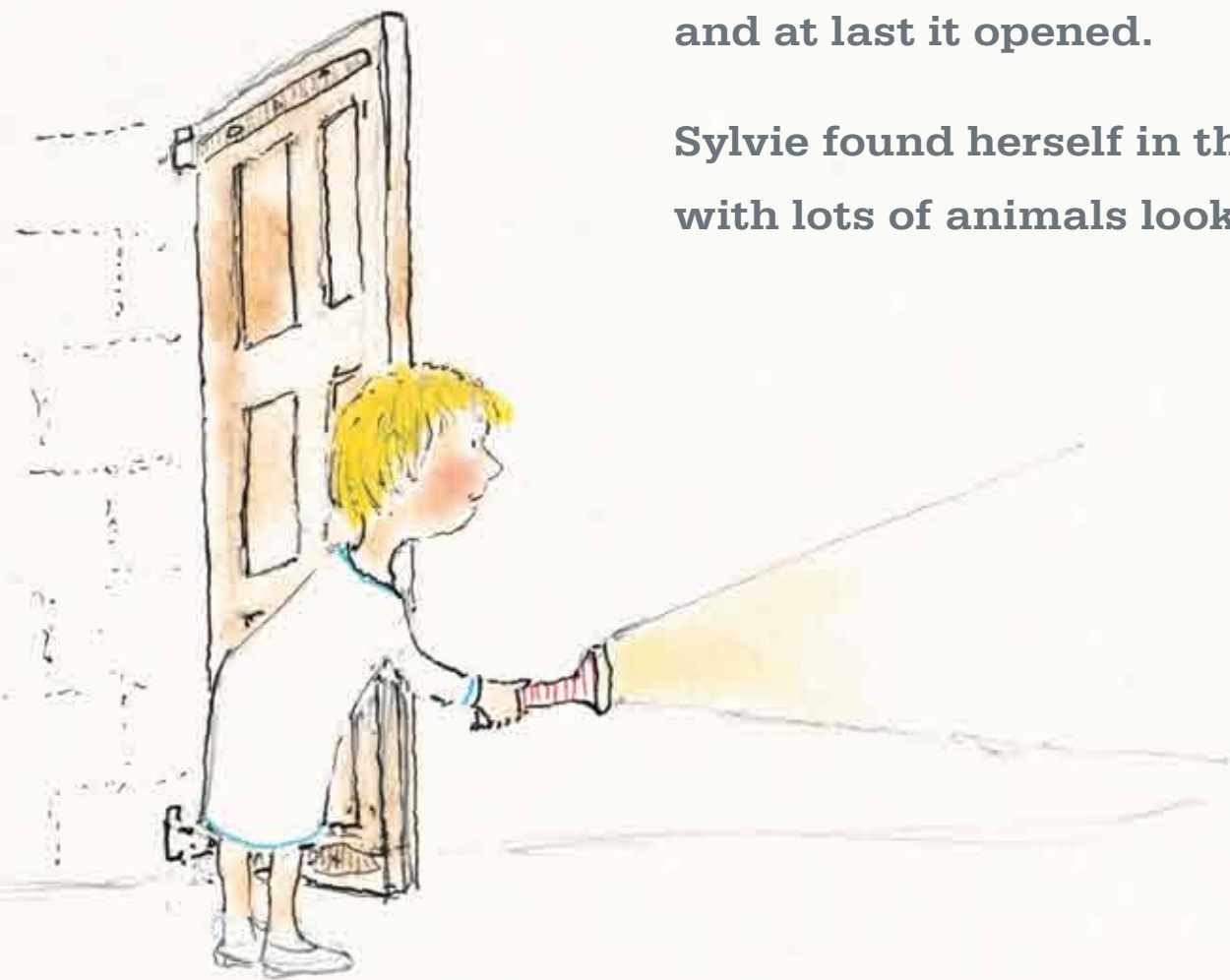

It was getting late. Sylvie had to get back to her room and go to sleep because it was school again in the morning.

Sylvie asked a little bear to come back with her and the bear slept in her bed.

She had to make sure the bear was back in the zoo and the door in her wall was closed before she went to school.

